

1. Content

2. INTRODUCTION	4
3. GENERAL INFORMATION	4
3.1. INFORMATION ABOUT THE MANUAL	4
3.2. INFORMATION ABOUT THE MACHINE	5
3.2.1. IDENTIFICATION PLATE	5
3.2.2. MACHINE FEATURES	5
3.2.3. IDENTIFICATION OF COMPONENTS	6
3.2.4. TECHNICAL DATA	6
4. SAFETY INFORMATION	7
5. CONNECTIONS	10
5.1. CHECK THE LIFTING CAPACITY OF THE TRACTOR	10
5.2. CONNECTION TO THE TRACTOR'S THREE-POINT HITCH	11
6. USING THE MULCHING MACHINE	11
6.1. GENERAL REGULATIONS	11
6.1.1. HITCH ADJUSTMENT	12
6.1.2. ADJUSTING THE LIFTING ARMS	12
6.2. LAYING THE PLASTIC	12
6.3. PLACEMENT OF THE IRRIGATION TAPE OR RUBBER	13
6.4. ERRORS IN THE PADDING	13
7. MAINTENANCE	14
7.1. STORAGE	14

2. INTRODUCTION

Agricultural mulchers are machines used to place plastic on the ground for planting vegetables, and can be used with both small and medium-power tractors.

It is recommended to carefully read this use and maintenance manual and scrupulously abide by the indications described before carrying out any use, control and operation that must be carried out with and on the machine.

This manual has been drawn up to provide the Customer with all the information about the machine and about the safety regulations related to it, as well as the instructions for use and maintenance that allow to take full advantage of the potential of the machine.

The manual must always be within reach so that it can be consulted to control the operating cycle. If it is lost or damaged, a replacement copy must be requested.

If you encounter difficulties in interpreting the texts or the tables or if the drawings/diagrams are not clear enough, we ask you to contact the manufacturer or the dealer of the machine to immediately have all the clarifications through the operation/maintenance experts or those responsible for drafting the manual.

We are at the complete disposal of the users, the commercial managers and any other interested person, for a useful collaboration tending to improve the complete understanding of the manual.

3. GENERAL INFORMATION

3.1. INFORMATION ABOUT THE MANUAL

This manual provides all the information for the use and maintenance of the machine. The proper functioning and its duration will depend on correct maintenance and care during use.

Some illustrations in this manual show parts or accessories that may be different from your machine; some component may have been removed to ensure understanding of the illustrations.

Appropriate pictograms have been applied to the machine. It will be the operator's task to keep them in perfect visual condition and replace them when they are no longer legible.



ATTENTION! - WARNING!

During the period of use, maintenance, repair, manipulation or storage of the machine, the operator must wear safety shoes and gloves. If necessary, you should also wear noise-cancelling headphones, a dust mask, and goggles.

It is recommended to use original spare parts and accessories.

Non-original parts, in addition to voiding the warranty, could be dangerous, reducing the duration and performance of the machine.

3.2 INFORMATION ABOUT THE MACHINE

The machine models presented in this manual have been exclusively designed and manufactured to place plastic on the ground for planting vegetables. The machine is not indicated to be used in sectors other than agriculture.

This machine is generally used during the day; if its use is required at night or in conditions of reduced visibility, the tractor lighting system must be used.

A use other than that specified is considered improper.

Any arbitrary modification made to this machine releases the manufacturer from any liability for damages or injuries, even serious, that may result to the operators, third parties and objects.

3.2.1 IDENTIFICATION PLATE

On the frame of each machine is applied a plate that indicates the model, the serial number, the year of manufacture of the machine and its weight.

When ordering spare parts it is always necessary to refer to the type of machine, the frame number and the year of manufacture.

3.2.2. MACHINE FEATURES

The quilting mod . MP1HRM is characterized by a plastic unwinder activated by the same movement of the machine, calculated to obtain maximum unwinding precision and uniformity in its placement.

They are provided with opening bars at the rear of which the ground is left prepared so that the ends of the plastic remain at a lower ground level. By means of other rear bars, the earth is deposited on the base of the ridge for its fixation to the earth.

epoxy paint baked at 150°C with the application of the bottom coat in a bath to guarantee great protection and a long duration of the machine.

Some models have a rubber distributor or drip irrigation tape, placing the tape or rubber in the same mulch operation.

3.2.3. COMPONENT IDENTIFICATION

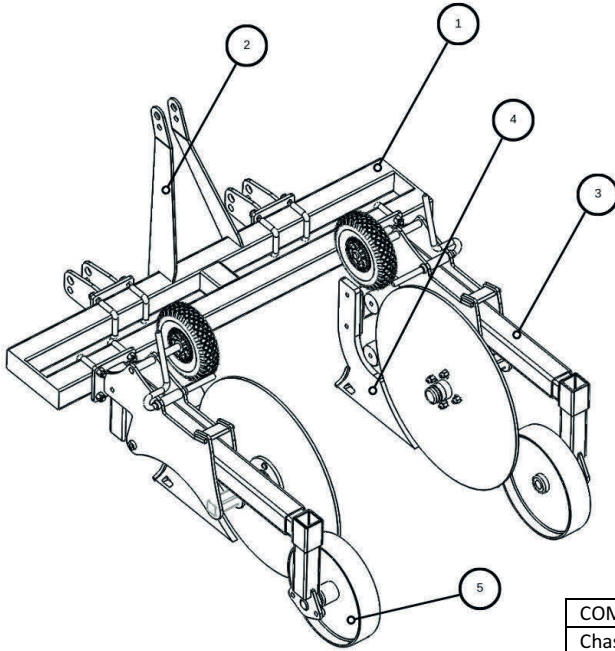

COMPONENTS	ID
Chassis	1
three-point hitch	2
Quilting Arm	3
Opening Grille	4
compact wheels	5

3.2.4. TECHNICAL DATA

MODEL	WORKING WIDTH	ADMITTED PLASTIC WIDTH	WEIGHT	TRACTOR POWER
MP1HRM	1800mm	600mm – 2500mm	300	>25hp

4. SAFETY INFORMATION

THE FOLLOWING SAFETY PRESCRIPTIONS ARE SERVED TO PROTECT ITS SAFETY: IT IS NECESSARY THEN TO READ THEM CAREFULLY, MEMORIZE THEM AND ALWAYS APPLY THEM.

The warnings in this manual refer exclusively to uses that are permitted and that are reasonably foreseeable. The indications presented below must be integrated with the prudence and experience of the person who works, elements that are essential to prevent misfortunes.

The machine must be used by a single operator. Do not let minors use the machine.

All the instructions presented below must be carefully followed.

Any modifications to the tool that have not been previously authorized by the Manufacturer (in writing), exclude its responsibility.

Carefully check the machine before each start-up.

General tips:

- Read this manual carefully before carrying out start-up, use, maintenance or other interventions on the machine.
- Observe, in addition to the warnings contained in this manual, all general safety and accident prevention regulations.
- The manual must always be within reach, so that it can be consulted to verify the operating cycle and information about safety. If it is lost or damaged, you will need to order a replacement copy.

	<p>ATTENTION</p> <p>Any maintenance, adjustment and cleaning work must be carried out with the machine on the ground (in stable conditions), the tractor engine off, the hydraulic motor disconnected, the handbrake on, the ignition key off and removed from the boot box.</p>
---	---

- Carefully read the safety pictograms applied to the machine and follow the instructions. In the event of deterioration or poor legibility of the safety pictograms, clean or replace them, placing them in the exact position, as described in paragraph 3.1

<p>ATTENTION! - WARNING!</p> <p>During the period of use, maintenance, repair, manipulation or storage of the machine, the operator must wear safety shoes and gloves. If necessary, you should also wear noise-cancelling headphones, a dust mask , and goggles.</p>	
--	---

- The machine is designed to be used by a single operator who, during use, must always remain at the control post on board the tractor.
- Never work with this machine if you are tired, ill or under the influence of alcohol, drugs or medicine.



DANGER!

It is forbidden to get on or be carried by the moving machine.

Do not place or remove the plastic or the irrigation rubber while the machine is find working.

- Keep the machine clean of foreign materials (debris, tools, miscellaneous objects) that could impair operation or cause injury to the operator.
- If pressurized air or water is used for cleaning operations, it will be necessary to wear protective glasses and masks and move any people or animals away from the vicinity of the machine.
- Before connecting the machine to the tractor or other self-moving means, make sure that it is in good condition and that the brakes work correctly, especially if you are working on sloping ground.
- Disconnect the machine from the tractor only on compact and horizontal ground, checking that it is stationary and stable.



ATTENTION!

The Manufacturer is not responsible for any damage caused by an unforeseeable or improper use of the machine.

The manufacturer is considered free of any liability in case of:

- serious deficiencies in the planned maintenance;
- unauthorized modifications or interventions;
- use of non-original or model-specific spare parts;
- total or partial non-observance of the instructions;
- non-observance of common safety standards in the workplace;
- exceptional events.

Connecting the machine to the tractor

- The three-phase clutch of the tractor and the mulcher must match or be adapted.
- The presence of the machine can influence the maneuverability of the tractor, especially during transport.

machine operation

- Check the machine before each start-up. Start work only if the machine is in perfect condition.
- Before using the machine, it must be ensured that all the safety devices are correctly placed in place and in good condition; if faults or damages are found in the protections, they must be replaced immediately.



ATTENTION!

During work, it must be ensured that there are no people or animals within the 50 meter radius. When working near roads or public places, it is **ABSOLUTELY MANDATORY** to move people away and increase prudence.



ATTENTION!

Anyone who approaches the machine is in a danger zone and therefore becomes an "EXPOSED PERSON". The operator has to prevent anyone from entering the danger zone and operate himself with the utmost care. If someone approaches, the tractor engine must be stopped immediately.

- Before any use of the mulcher, it is always necessary to check the state of wear of the opening gates. Check that the fixing elements (screws and nuts) are present and well fixed.
- The machine must not be left unattended when it is in motion.
- Always keep the machine in good operating condition and carry out maintenance regularly.

road transfer



ATTENTION!

The traffic code in force in the country of employment must be strictly adhered to.

During transfers on public roads, it is mandatory to empty the contents of the hopper.

- Along with respecting the rules, it should be remembered that when driving on public roads, particular attention must be paid, in addition to any particular prescriptions noted in the tractor's traffic manual, to the choice of an appropriate transfer speed, especially when there is heavy traffic on the road, when it is winding or sloping.
- In the event that the mulch hides the rear indicator lights of the tow vehicle due to its size, it will be necessary to apply a repetitive light bar and/or rear indicator signs.
- When entering the highway after work, attention must be paid to cleaning the tires or work equipment, to avoid soiling the road surface with dirt or other material.



ATTENTION!

While driving on the road, the yellow or orange flashing light device mounted on the tractor must always remain in operation, even during the day.



ATTENTION!

During transport with the machine raised, always ensure that the front linkage control lever is locked to prevent accidental lowering of the machine.

5. CONNECTIONS

Before hitching the machine to the three-point linkage, position the tractor safety device in such a way that it is impossible to raise and lower the arms involuntarily and/or accidentally.

There is still a risk of injury near the tie rods of the rear linkage of the tractor due to crushing and cutting points.

Do not use the external control to raise the tool.

In the transport position, the lateral stop of the tie rods must be locked.

5.1 CHECK THE LIFTING CAPACITY OF THE TRACTOR



DANGER!

It is mandatory to check the lifting capacity and stability of the tractor (before coupling with the machine) to prevent it from tipping over and/or the wheels losing grip.

Check the lifting capacity and stability of the tractor using the following formula and, if necessary, pre-apply the counterweights.

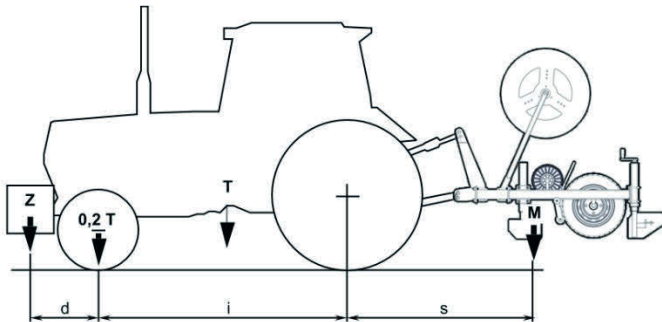

$$M s \leq 0,2 T i + Z (d + i)$$

$$M \leq 0,3 T$$

i	=	distancia entre los ejes ruedas tractor
d	=	distancia del eje delantero de los contrapesos
s	=	distancia del eje anterior de la máquina operadora
T	=	masa del tractor + 75 Kg. (operador)
Z	=	masa de los contrapesos
M	=	masa de la máquina

5.2 CONNECTION TO THE THREE-POINT HITCH OF THE TRACTOR

To connect the machine to the tractor, follow the instructions below:

- Back up the tractor until you are close to the bottom links of the mulcher.
- Attach the lower hitches of the tractor to the pins of the machine and lock them with the safety pins.
- Once this operation has been carried out, connect the upper hitch of the machine to the third point of the tractor by inserting the corresponding pin and lock the anti-unscrewing device of the third point;
- Raise the machine a few centimeters from the ground and, acting on the lateral braces of the lift bars and on the two tensioners, block its lateral movement to prevent excessive oscillations during the processing phase.

6. USING THE MULCHING MACHINE



ATTENTION!

During the use of the machine, it is necessary to make sure that there are no people or animals in the radius of 50 meters. If someone approaches, work must be stopped immediately and the tractor engine stopped.

There are several factors that can determine a correct placement of the plastic, such as: the speed of advance, the driving of the machine, the quality of the plastic used and the roughness of the terrain.

6.1 GENERAL REGULATIONS

Plastic must always be properly stored and preserved in order to maintain its physical properties unaltered.

It is necessary to establish the ground speed of the tow vehicle before starting mulching and try, as much as possible, to keep it constant throughout its duration.

Said adjustment must be carried out depending on the type of plastic used and the experience of the operator.

The contribution of earth to fix the plastic to the ground is regulated by means of the levers located in the upper part of the rear blades.

6.1.1. HITCH ADJUSTMENT



Through the existing flanges on the belts you can adjust the distance between hitches depending on the tractor that is going to be used.

6.1.2. ADJUSTING THE LINK ARMS

Using the existing flanges on the arms, you can adjust the distance between them depending on the length of the plastic roll to be used. The mulch accepts plastic rolls between 40 and 160 cm in length.



6.2 LAYING THE PLASTIC



ATTENTION!

The plastic should only be placed after the mulcher has been connected to the tractor. Make sure that the large wheels are not in contact with the ground.

During the placement of the plastic, the tractor engine must be stopped, the control panel key disconnected and the parking brake applied.

The plastic roll must be unrolled as indicated in the figure for the correct operation of the machine.

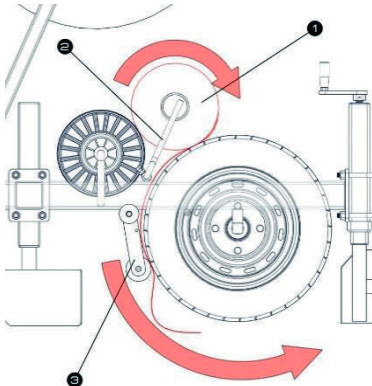

STEPS

1. Place the roll of plastic on the large and small wheels. The roll should protrude about 8-10 cm outside the wheels.
2. Use the stop rods to adjust the roll and prevent lateral displacement, leaving 1 cm of slack.
3. Turning the wheels in the direction of the arrows will unroll the plastic. Pull the lever to separate the nylon pulley and release it once the plastic has reached the floor.

6.3. PLACEMENT OF THE IRRIGATION TAPE OR RUBBER

If the mulcher is equipped with a reel for the placement of tape or irrigation rubber, follow these steps:

1. Remove the side of the spool by loosening the clamp screw.
2. Place the roll of tape or glue on top of the rods.
3. Put the side of the spool back on and push so that the roll is securely attached. Retighten the fixing screw.
4. Insert one end of the rubber or tape through the guide tube of the quilting chassis.

6.4. ERRORS IN THE PADDING

Operation errors

- Wrong spread width.
- Tractor forward speed not suitable for that specific type of plastic.
- Driving errors (non-overlapping spreading surfaces).
- Lack of cleaning of the front or rear bars.

Errors due to plastic

- Poor quality plastic.
- Wet or excessively damp plastic.
- Foreign bodies in the plastic.

Errors due to the machine

- Insufficient tire pressure.
- Worn or damaged bars.



7. MAINTENANCE

The recommended criteria for ordinary maintenance of the machine are now illustrated, based on the experience of the company and the advice and suggestions given by our customers.

These criteria are not exhaustive but can be further integrated also with the collaboration of the clients themselves, to whom we thank in advance.

Good ordinary maintenance keeps the cost of operating the machine low and allows full use of its potential.



ATTENTION!

Any maintenance, adjustment and cleaning work must be carried out with the machine on the ground (in stable conditions), the tractor engine off, the power take-off disconnected, the parking brake on, the ignition key off and removed from the boot box.

In the event of a fault, the operator must immediately stop the machine, verify the extent of the problem and carry out any interventions on the machine.

If pressurized water or compressed air is used to clean the machine, it is necessary to protect yourself with appropriate protective glasses or masks and keep any people or animals away from the vicinity of the machine. Do not use flammable fluids.



ATTENTION!

For maintenance operations, you must always use the appropriate Personal Protection Equipment (safety shoes and work gloves) and prepare all the forms of accident prevention provided for the type of operation in progress.

Every 8 hours of effective work, the tightness of all the nuts and bolts must be checked.

For particular interventions that are not known or replacement of damaged parts not covered in this Manual, it is necessary to resort to specialized personnel, making use of the Manufacturer's Assistance Service or its dealers.

7.1 STORAGE

It is advisable not to wait to use the machine to carry out repair and maintenance interventions. Parts that are broken or damaged must be repaired and replaced before storing the machine, in order to always have it ready for use.

Store the machine in a place sheltered from atmospheric agents and protect it to prevent it from deteriorating.

Before putting the machine to rest for long periods, it is advisable to follow the instructions below:

- carefully wash the machine and the inside of the blades;
- carry out a general visual inspection of the machine to identify any structural damage, detect any deep abrasions in the paint;
- grease all the mechanical parts - if possible, store the machine in a covered place.

